

D-SERIES REPLACEMENT PARTS

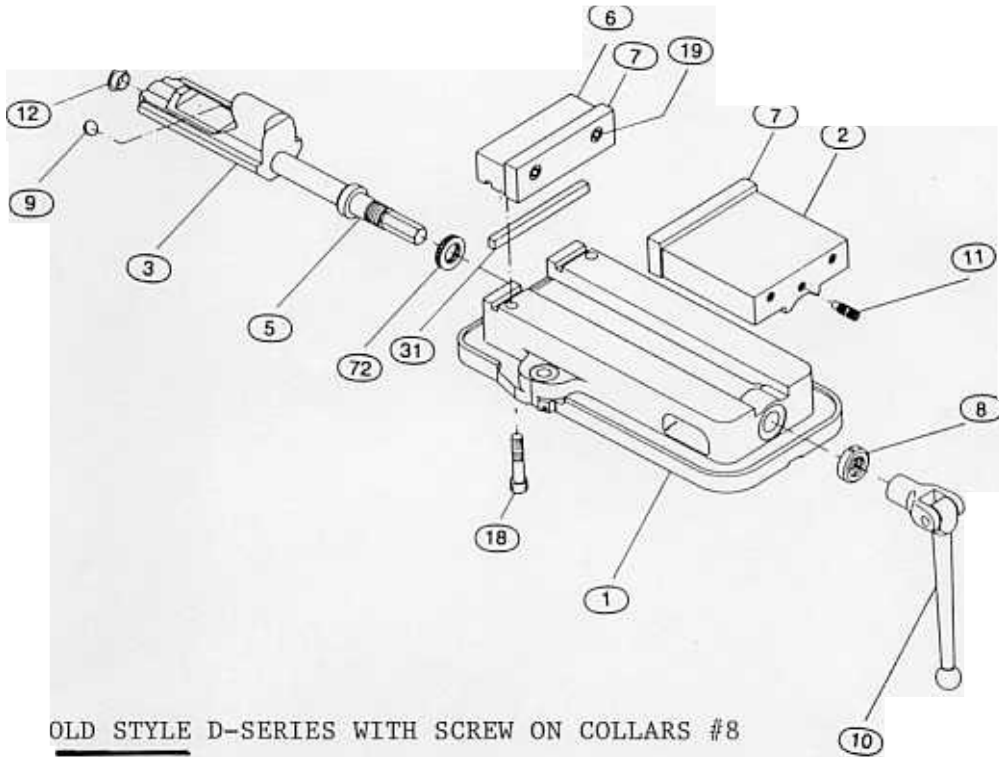

PART NAME	PART NUMBER	QUANTITY NEEDED	D30 VISE	D40 VISE	D50 VISE	D60 VISE	D80 VISE	D100 VISE
BODY	1	1						
MOVABLE JAW	2	1						
NUT	3	1						
SCREW	5	1						
STATIONARY JAW	6	1						
JAW PLATE	7	2						
COLLAR ASSEM	8-SA	1						
SPHERICAL SEGMENT	9	1						
VISE HANDLE	10A-SA	1						
ADJUSTING SCREW	11	1						
END CAP (NUT)	12A	1						
*SHCS	18	2						
*SHCS	19	4						
STAT JAW KEY	31	1						
THRUST BRNG ASSY	SET 72	1						
THRUST BEARING	41	1						
THRUST WASHER	42	2						
* PART #18 SIZE OF SCREW			5/16-18 x 2	3/8-16x2-1/4	7/16-14 x 2-3/4	5/8-11 x 3	5/8-11 x 3 1/2	3/4-10 x 4-1/2
* PART #19 SIZE OF SCREW			5/16-18 x 3/4	3/8-16 x 7/8	7/16-14 x 7/8	1/2-13 x 1-1/4	5/8-11 x 1-1/4	3/4-10 x 1-1/2

To get the correct part number prefix the part number at the left with the vise model number and a hyphen.

**For example the part number for a D50 body is
D50-1**