

D688 REPLACEMENT PARTS

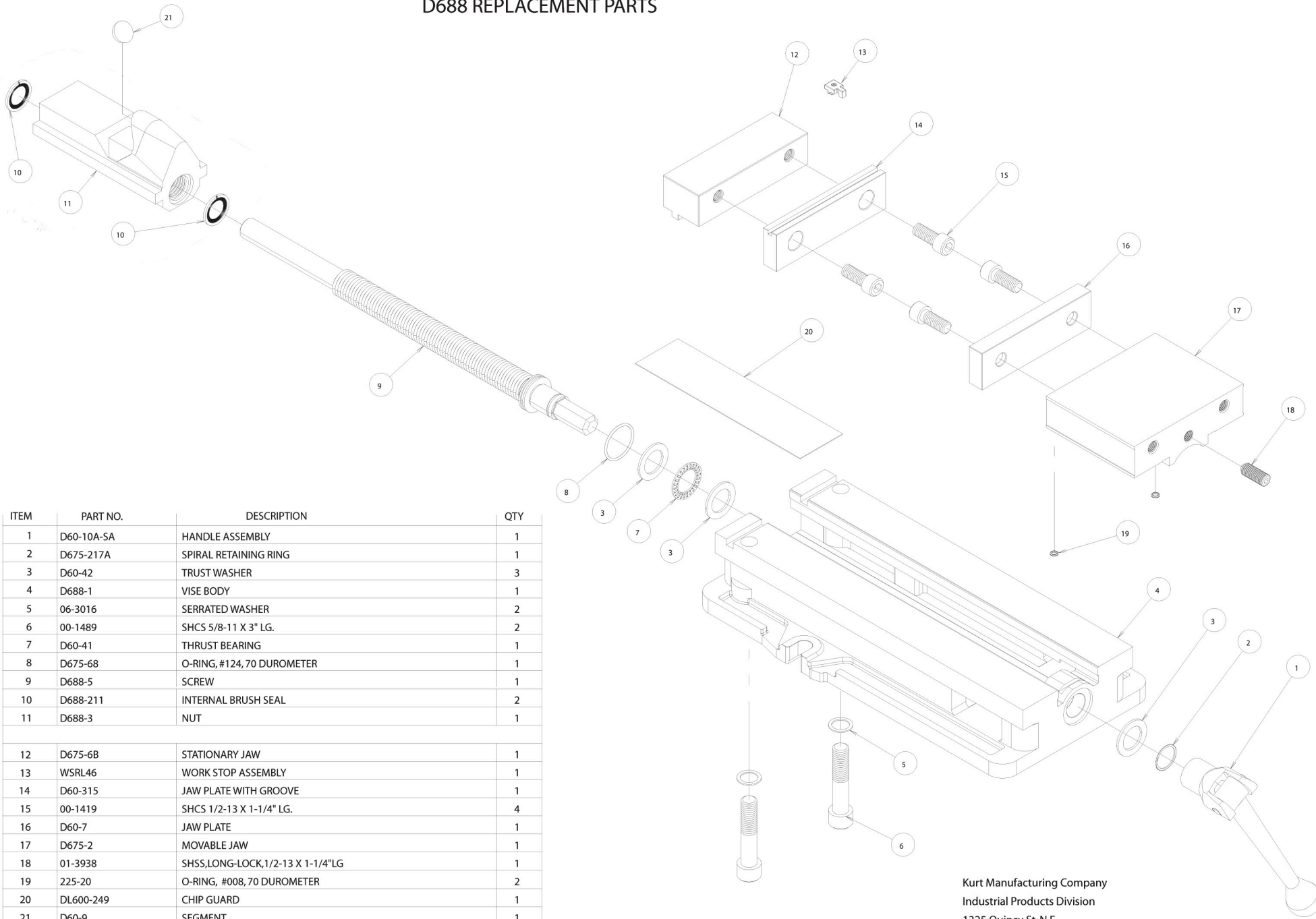

ITEM	PART NO.	DESCRIPTION	QTY	
1	D60-10A-SA	HANDLE ASSEMBLY	1	
*	2	D675-217A	SPIRAL RETAINING RING	1
*	3	D60-42	THRUST WASHER	3
	4	D688-1	WISE BODY	1
	5	06-3016	SERRATED WASHER	2
	6	00-1489	SHCS 5/8-11 X 3" LG.	2
*	7	D60-41	THRUST BEARING	1
*	8	D675-68	O-RING, #124, 70 DUROMETER	1
	9	D688-5	SCREW	1
*	10	D688-211	INTERNAL BRUSH SEAL	2
	11	D688-3	NUT	1
	12	D675-6B	STATIONARY JAW	1
	13	WSRL46	WORK STOP ASSEMBLY	1
	14	D60-315	JAW PLATE WITH GROOVE	1
	15	00-1419	SHCS 1/2-13 X 1-1/4" LG.	4
	16	D60-7	JAW PLATE	1
	17	D675-2	MOVABLE JAW	1
	18	01-3938	SHSS, LONG-LOCK, 1/2-13 X 1-1/4" LG	1
	19	225-20	O-RING, #008, 70 DUROMETER	2
	20	DL600-249	CHIP GUARD	1
*	21	D60-9	SEGMENT	1

* ITEMS INCLUDED IN REPAIR KIT P/N D688-KIT

Kurt Manufacturing Company
 Industrial Products Division
 1325 Quincy St. N.E.
 Minneapolis, MN 55413
 1-800-328-2565
www.kurtworkholding.com