

D810 REPLACEMENT PARTS

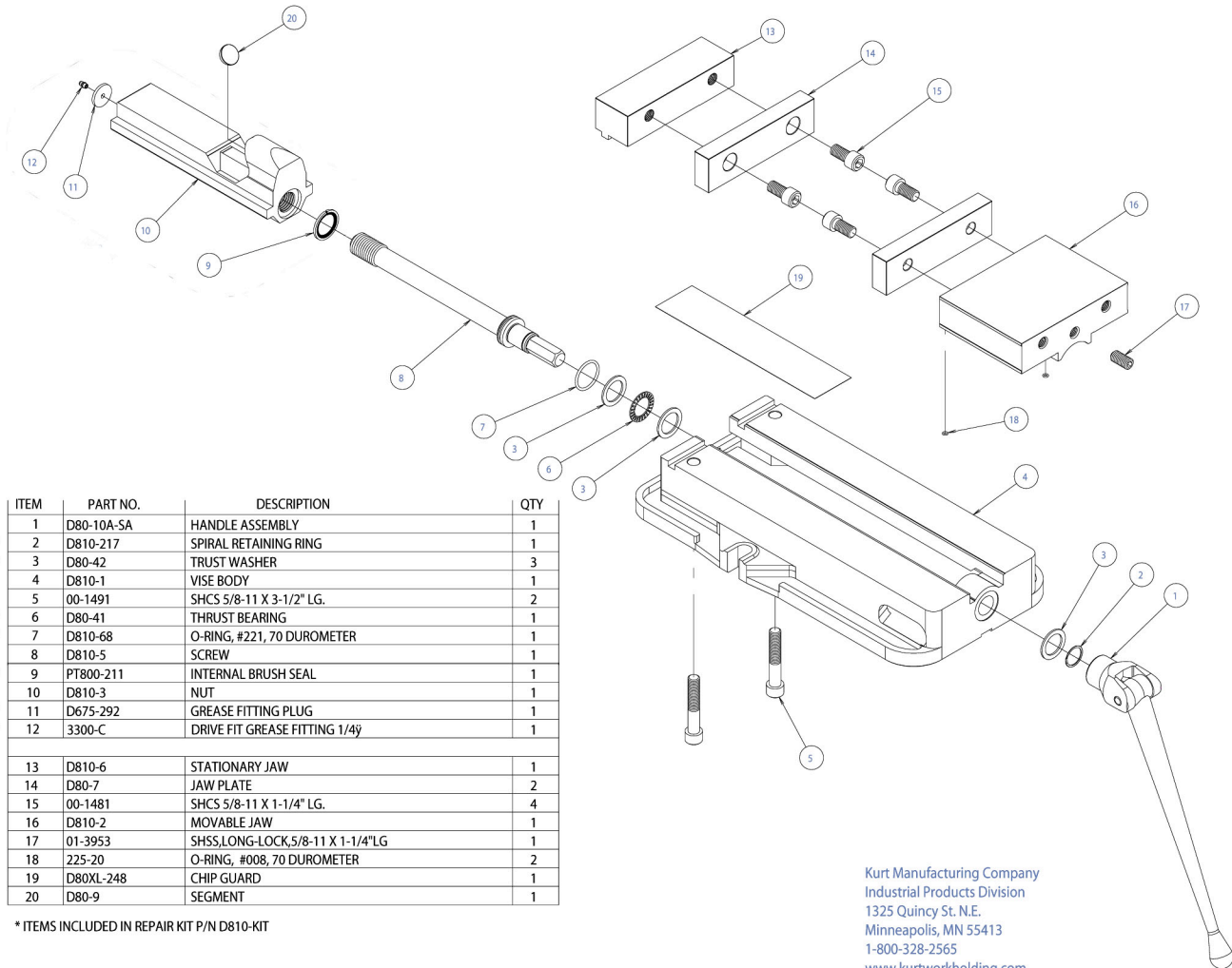

ITEM	PART NO.	DESCRIPTION	QTY
1	D80-10A-SA	HANDLE ASSEMBLY	1
* 2	D810-217	SPIRAL RETAINING RING	1
* 3	D80-42	TRUST WASHER	3
4	D810-1	WISE BODY	1
5	00-1491	SHCS 5/8-11 X 3-1/2" LG.	2
* 6	D80-41	THRUST BEARING	1
* 7	D810-68	O-RING, #221, 70 DUROMETER	1
8	D810-5	SCREW	1
* 9	PT800-211	INTERNAL BRUSH SEAL	1
10	D810-3	NUT	1
* 11	D675-292	GREASE FITTING PLUG	1
* 12	3300-C	DRIVE FIT GREASE FITTING 1/4"	1
13	D810-6	STATIONARY JAW	1
14	D80-7	JAW PLATE	2
15	00-1481	SHCS 5/8-11 X 1-1/4" LG.	4
16	D810-2	MOVABLE JAW	1
17	01-3953	SHSS, LONG-LOCK, 5/8-11 X 1-1/4" LG	1
18	225-20	O-RING, #008, 70 DUROMETER	2
19	D80XL-248	CHIP GUARD	1
20	D80-9	SEGMENT	1

* ITEMS INCLUDED IN REPAIR KIT P/N D810-KIT

Kurt Manufacturing Company
 Industrial Products Division
 1325 Quincy St. N.E.
 Minneapolis, MN 55413
 1-800-328-2565
www.kurtworkholding.com