

DL400C &

DL400A™ REPLACEMENT PARTS

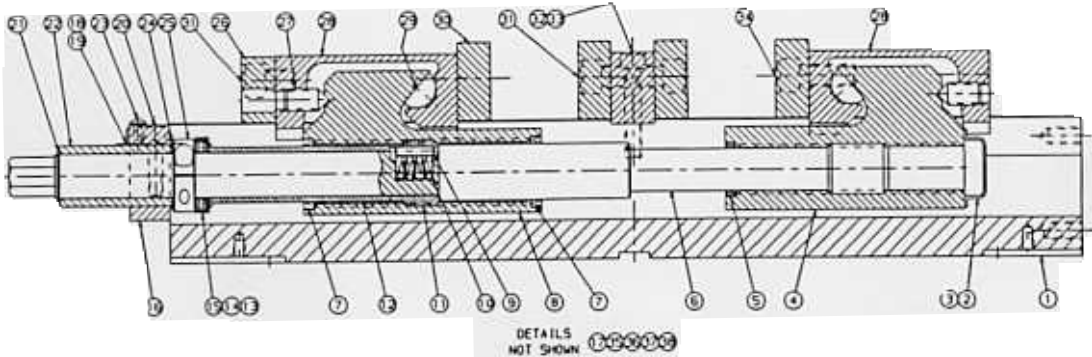

ITEM	QTY	DESCRIPTION	PART NUMBER
1	1	BODY	DL400-IC
2	1	END CAP	DL400-218
3	4	U-TYP. DRIVE SCREW #2 X 1/4	07-0230
4	1	REAR NUT	DL400-3RA
5	1	U-CUP SEAL	DL400-146
6	1	SCREW	DL400-5A
7	2	U-CUP	DL400-180
8	1	FRONT NUT	DL400-3FA
9	1	DOWEL PIN 3/16 DIA. X 7/8 LG.	04-0031
10	4	CLUTCH SPRINGS	DL600-215
11	1	CLUTCH	DL400-273
12	1	CLUTCH SPACER	DL400-274A
13	2	THRUST WASHER	DL400-42A
14	1	THRUST BEARING	D40-41
15	1	THRUST WASHER COLLAR	DL400-272A
16	1	HOLDING BLOCK	DL400-212C
17	1	SERIAL NUMBER TAG	DL400A-102A
18	2	COMPRESSION SPRING	DL400-197
19	2	SHLD. SCREW 1/2 DIA. X 1/2 LG.	DL400-176A
20	1	SHCS 1/4 - 20 X 1 LG.	00-1293
21	1	RETAINING RING (EXTERNAL)	DL400-217
22	1	SLEEVE	DL400-209
23	2	BHCS #10-24NC X 3/8 LG.	03-0124
24	1	THRUST WASHER (.03 THICK)	TRA-1220
25	1	DOUBLE SPLIT COLLAR	DL400-8
26	1	RETAINING PLATE	DL400-227
27	2	SHSS CONE PT. 3/8 - 16 X 3/4 LG.	01-3307
28	2	MOVEABLE JAW	DL400-2
29	2	SEGMENT	D40-9
30	4	JAW PLATE	D40-7
33	1	STATIONARY JAW	DL400-6B
34	4	SHCS 3/8 - 16 X 7/8 LG.	00-1353
35	1	T-HANDLE WRENCH (3/16 HEX)	DL400-219
36	1	HANDLE ASSEMBLY	D40-10-SA
37	2	CHIP GUARD (SHORT)	DL400-248
38	1	CHIP GUARD (LONG)	DL400-249
39	2	BUSHING	DL400-213A

* FOR MFG. PURPOSES/ THE SET PART NUMBER IS DL400-349-JIT = 100.00