

PFA620 PRECISION FORCE AIR OPERATED VISE

Operating Instruction Manual

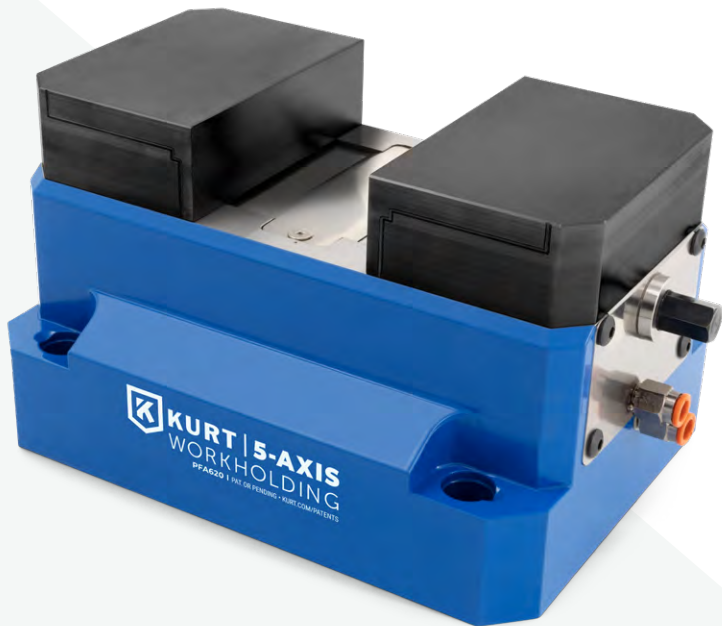

TABLE OF CONTENTS

Introduction	3
Operating Instructions.....	3
Installation & Mounting Guide	4
Jaw Installation	5
Jaw Positioning	6
Side & End View	7
Machining the Carvable Jaws	8
Maintenance Schedule.....	9
Warranty.....	10

WISE DATA

Use this to fill out information about your vise for quick reference.

Purchase Date: _____ - _____ - _____

Purchase Order: _____

Purchased From: _____

Delivery Date: _____

Serial No.: _____

NOTE: MAKE SURE TO REGISTER YOUR WARRANTY ONLINE AT KURTHOLDING.COM

INTRODUCTION

Thank you for purchasing a Kurt PFA620 Pneumatic 5-Axis Vise. Backed by a lifetime warranty against workmanship and material defects, these vises will perform at the highest levels of precision and reliability for years to come, when used and maintained properly.

Kurt AngLock maintains its time tested design, which gives you the part pull down that you need when machining high end parts.

The PFA620 vise comes standard with carvable 4140 prehard jaws.

PFA620 CLAMPING FORCE	
PNEUMATIC PSI	FORCE IN LBS.
50	925
60	1,025
70	1,275
80	1,475
90	1,675
100	1,875
110	2,000

OPERATING INSTRUCTIONS

To properly clamp a part in your Kurt vise you should place the part in the center of the jaws. Clamping only on one side can result in loss of accuracy. If one-sided clamping is necessary you **MUST** use a dummy part on the other side.



WARNING

When clamping parts, only use the hex to pre-position the jaws. Tighten to approximately 0.06 inch from touching the part, then use pneumatics to clamp the part.

INSTALLATION & MOUNTING

The PFA620 vise is mounted using the counterbores machined into the vise body, which are sized for 3/8 SHCS. To locate the vise precisely, two 0.250" dowel holes are also located on the centerline of the bottom surface of the vise body.

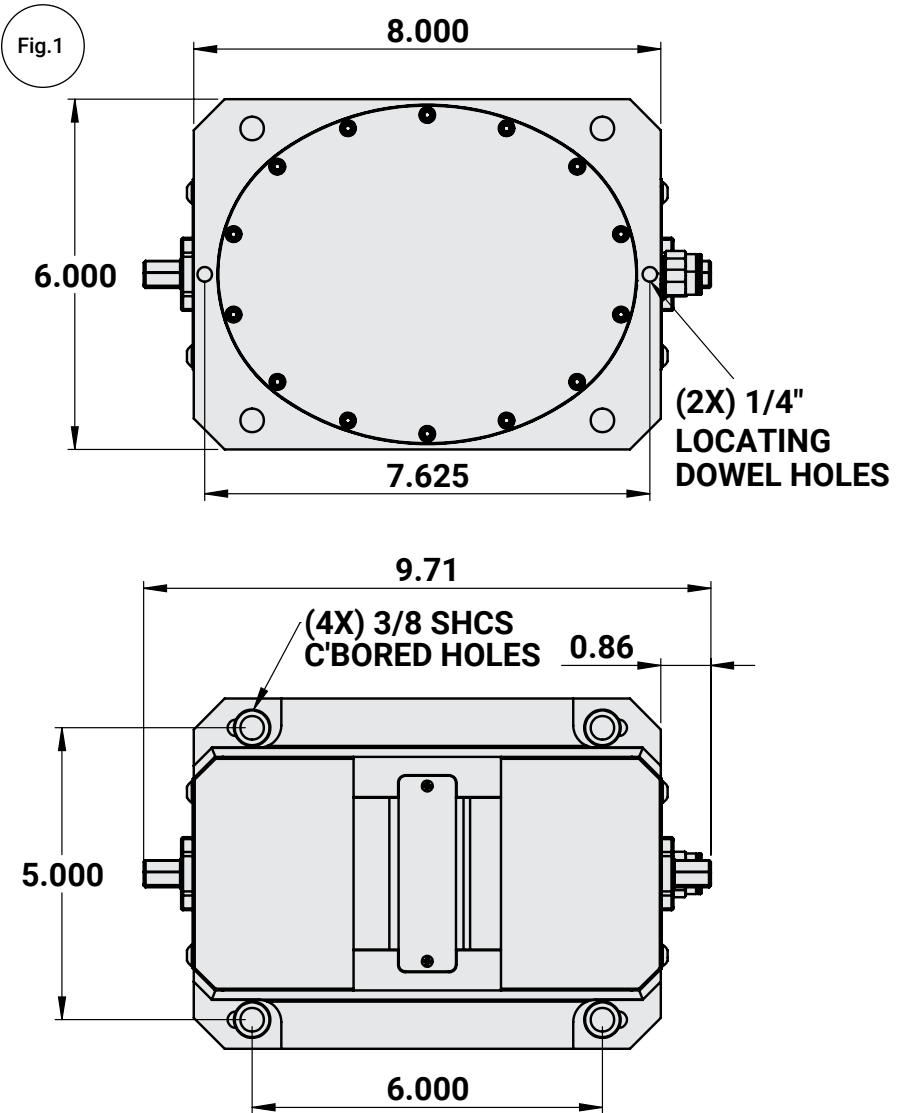

JAW INSTALLATION

The PFA620 vise must be all the way open to install jaws on the vise.

Failure to do this will result in damage to the chip guards.

Never try to open this vise beyond its limits as this will result in damage to the chip guards located at the end of the vise.

The jaws of this vise can be easily installed and removed by hand.

1. Grasp the jaw with two hands with your fingers towards the center of the vise and your thumbs to the back.
2. Place the forward bottom edge of the jaw against the vise as shown and slide jaw back to hook jaw on nut.
3. Snap the back of the jaw down and over the spring-loaded plungers to finish installation.
4. Reverse installation steps to remove jaws.

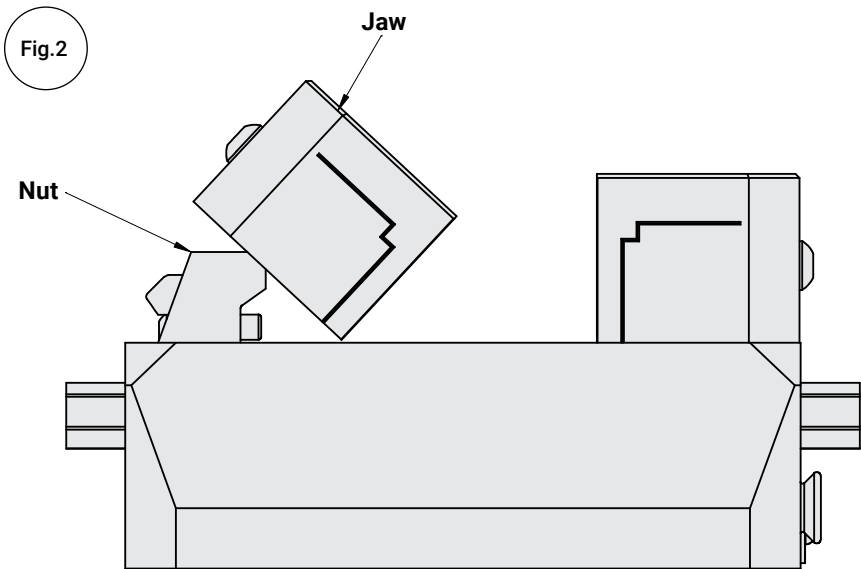
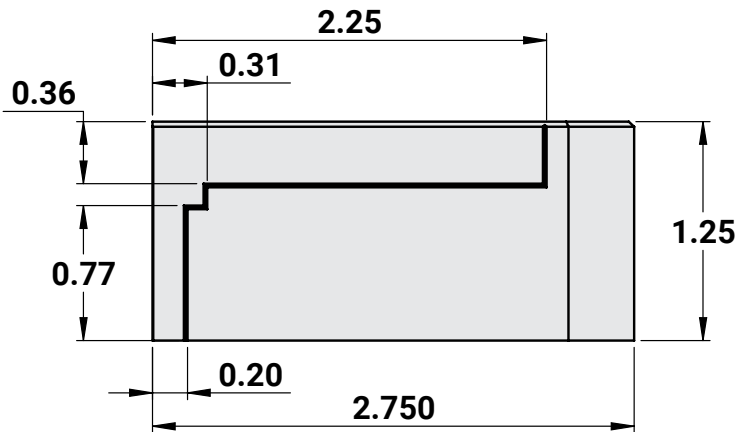
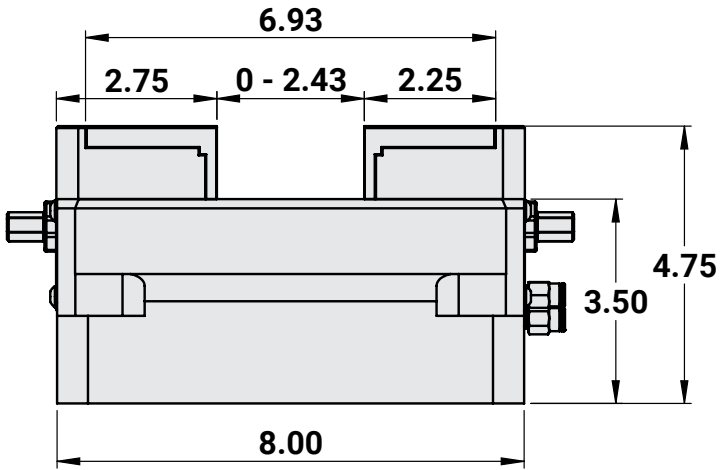

Fig.3

JAW POSITIONING

Note: Dimensions below are in inches unless specified.



CARVABLE JAW DETAIL

Fig.4

SIDE & END VIEW

Note: Dimensions below are in inches unless specified.

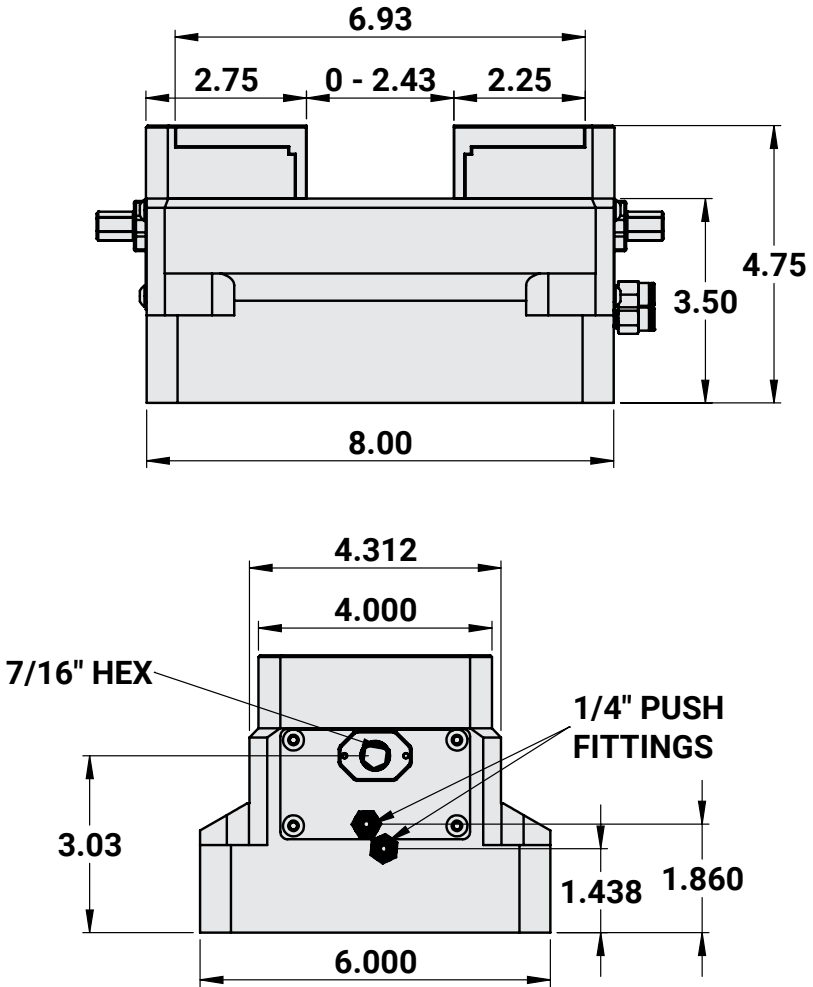

MACHINING THE CARVABLE JAWS

For the best results when machining the carvable jaws for Kurt vises, follow the procedure below.

1. Use parallels, vise hard jaws, or other precision cut blocks that are set just below the cut surface as shown in the Fig.5 below.
2. Clamp your precision blocks in the vise. For the best accuracy, clamp the vise to the same amount of torque you will be using during production when cutting your jaws.
3. **DO NOT** cut inside the boundaries of the scribed lines on the jaw blanks. Cutting inside of these lines will damage the internal features of the jaw. Dimensions are shown below.

Fig.5

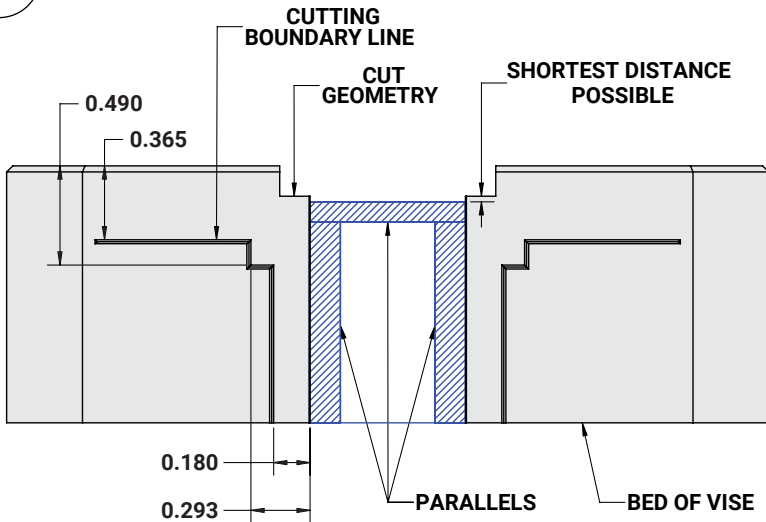

MAINTENANCE SCHEDULE

It is very important to perform regular maintenance on your Kurt vise to assure proper operation. Improper maintenance will result in poor vise performance and may void your warranty.

Daily/Weekly

1. Remove chips from surface of vise.
2. Visually inspect for chips, seals for damage and cleanliness.
3. Visually inspect for chip entrapments and remove when necessary.
4. Air-dry and apply rust inhibiting oil to the machined surface of the vise.

Monthly

1. Open the vise to the maximum opening.
2. Remove the movable jaws using the procedure on page 10.
3. Turn the movable jaw over and clean the inside cavity.
4. Remove any chips, clean and apply a light coat of machine oil to the machined surface of the following item
 - a. Nut and Screw assembly (clean exposed threads on the screw)
 - b. Bed of vise (top of "rails")
 - c. Inside of the vise between the center ways.
5. Your vise is now ready for use. Open and close your vise to check for proper operation. Center the part to be clamped in the vise and close. Your parts should be centered from side to side to insure proper clamping.

Yearly

The chip guards can be removed to allow access to the internals of the vise.

At this point you can grease some of the internals.

Use great care in returning the chip guards to their original positions.

Note: Only qualified professionals should attempt a full disassembly.

All Kurt Manufacturing Company industrial workholding products and parts with the exceptions noted below, are warranted against defects in material and workmanship for the life of the product or part. (The life of the product is defined as that point in time when such item no longer functions due to normal wear and tear.) Failure to properly maintain and/or properly operate the product or part that has been worn out, abused, heated, ground or otherwise altered, used for a purpose other than that for which it was intended, or used in a manner inconsistent with any instructions regarding its use. The sole obligation of Kurt Manufacturing Company, Inc. (Kurt) and the purchaser's **SOLE AND EXCLUSIVE REMEDY** hereunder, shall be limited to the replacement or repair of any Kurt product or part (by an authorized Kurt technician) which are returned to Kurt Manufacturing Company's place of business or any authorized service center, transportation, shipping and postal charges prepaid, and there determined by Kurt Manufacturing Company to be covered by the warranty contained herein.



THE LIMITED WARRANTY DESCRIBED HEREIN IS MADE EXPRESSLY IN LIEU OF ANY OTHER EXPRESSED OR IMPLIED WARRANTIES, INCLUDING ANY IMPLIED WARRANTY OF MERCHANTABILITY OR FITNESS FOR A PARTICULAR PURPOSE. KURT MANUFACTURING COMPANY IS NOT RESPONSIBLE FOR THE IMPROPER USE OF ITS PRODUCTS. KURT SHALL NOT BE LIABLE FOR ANY DIRECT, INDIRECT, INCIDENTAL SPECIAL OR CONSEQUENTIAL DAMAGES, INCLUDING BUT NOT LIMITED TO, LOSS OF USE, REVENUE OR PROFIT.

KURT ASSUMES NO LIABILITY FOR, AND MAKES NO WARRANTY REGARDING ANY PURCHASE ITEMS WHERE THE MANUFACTURER OF SUCH ITEM EXTENDS A SEPARATE WARRANTY.



KURT WORKHOLDING

Thank you for your
purchase! If you have any
feedback or questions
please contact us:

Kurt Industrial Products // A Division Of Kurt Manufacturing

9445 East River Road NW | Mpls, MN 55433
Phone 763-574-8309 | Toll Free 877-226-7823
Fax 763-574-8318 | Toll Free Fax 877-226-7823

kurtworkholding.com | workholding@kurt.com

Manual Revision:
01.08.2025